

Clarification 01

OLT2042981

Please see below model number breakdown:

OEM : Beta

Type : Pressure Switch

Model No: **C1-P302L-S7B-S6-G1-C-X1**

Serial No: **20601812**

C1: IP66 Enclosure

P302L: Range: 0-100mbar

S7B: Process connection: ½”M

S6 : Diaphragm: SS316

: O-ring: EPDM

G1: Switching element: low voltage circuit (Gold contacts)

: 3-way terminal block

C : Cable gland (weather proof IP66, Ex c, Ex I, Ex d classification enclosure)

X1 : means pressure switch only has one special (this is referring to the flanged connection ¾” ANSI or 3” DIN, this hosts the diaphragm as well as the O-ring)

The **DG-4346AS0290** number is the certificate documentation number

I've attached Dimensions of the C-series pressure switch as well as name plate and picture of the pressure switch.

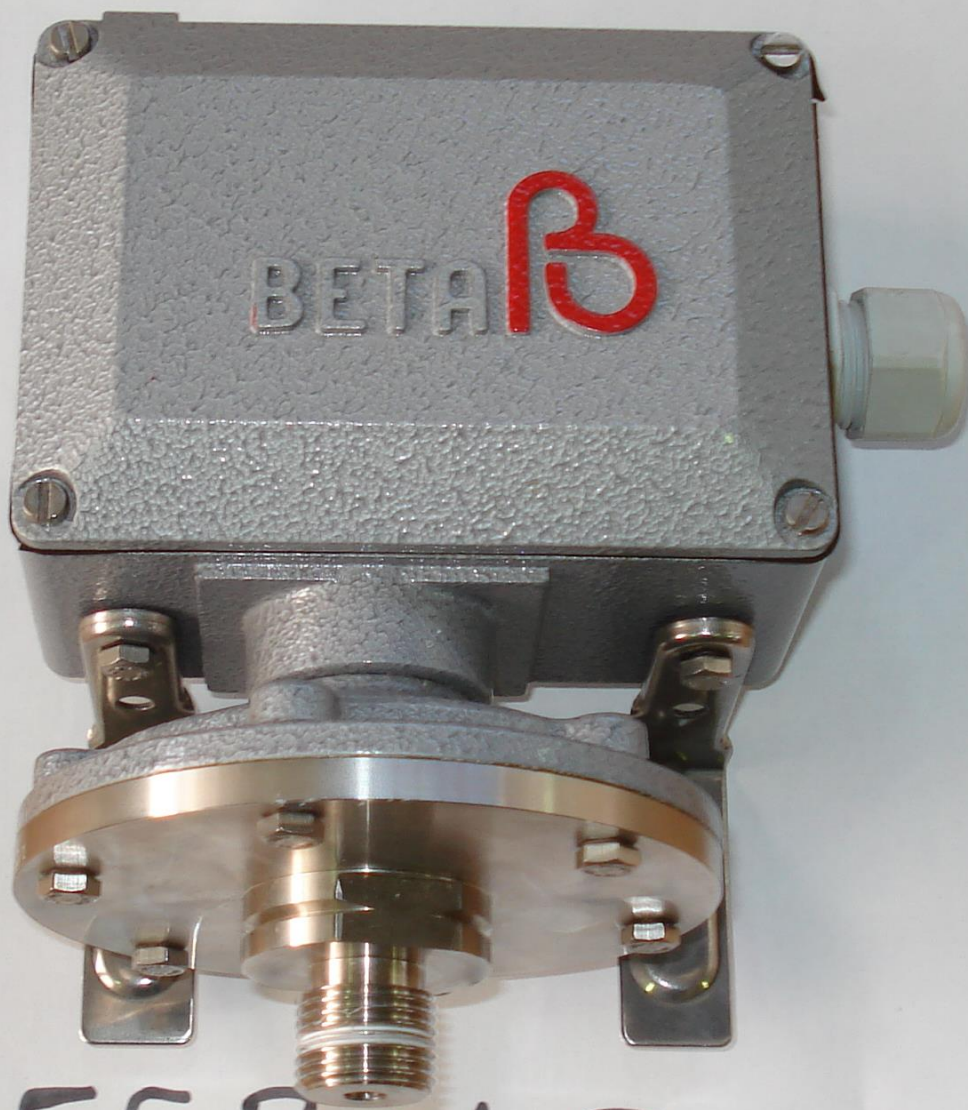

553113

DIMENSIONS

"C"- Series: Pressure & Vacuum "P...H"

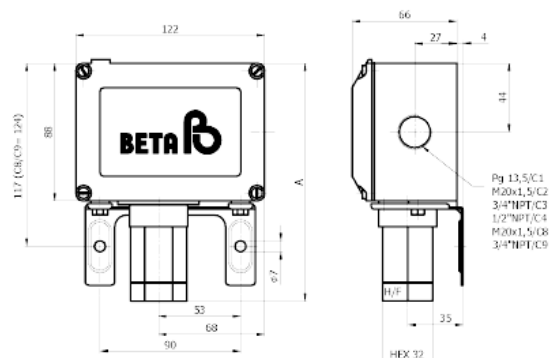

"W."- Series: Pressure & Vacuum "P...H"

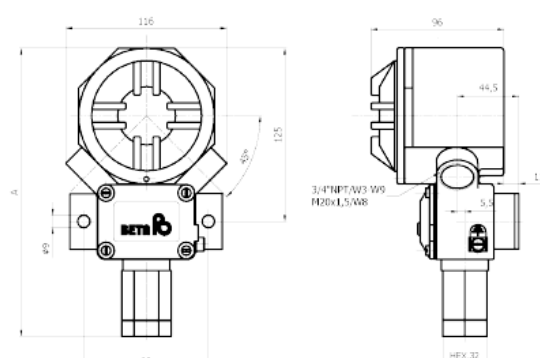

"C"- Series: Pressure & Vacuum "P...M"

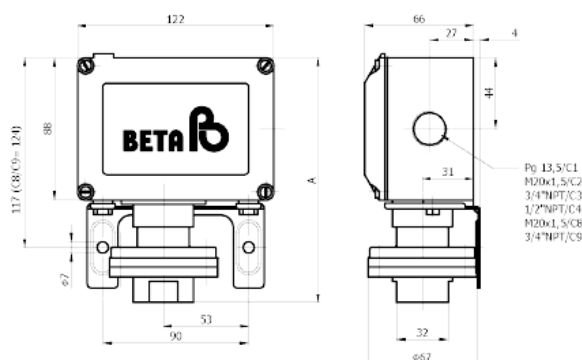

"W."- Series: Pressure & Vacuum "P...M"

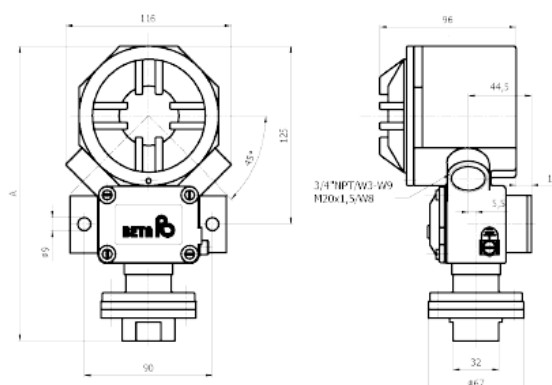

"C"- Series: Pressure & Vacuum "P...L"

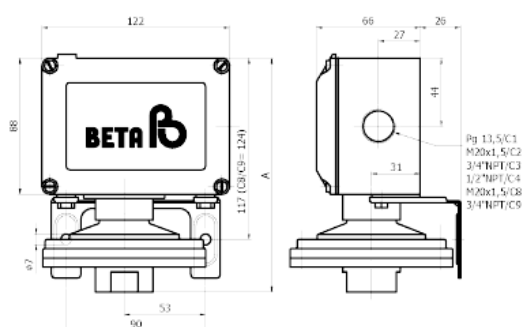

"W."- Series: Pressure & Vacuum "P...L"

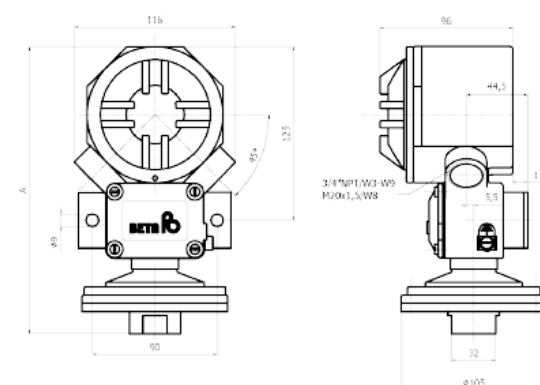

** For specific details about the dimension "A" please consult your BETA representative.

MODEL

BETAR SWITCH



C1-P302L-S7B-S6-G1-C-X1

0035

RANGE

10-100 KEAR

SERIAL No:

20601812

OVERRANGE PROOF

TAG No:

30

35 KEAR

U max.-V

I max.-A

125

1

AC

28

0.5

DC

UG-4346430230

BETA BV - VERRIJN STUARTLAAN 22 - 2288 EL RIJSWIJK - NL